

GEMINI Technologies S.r.l.
Via Luigi Galvani 12 - 21020 Bodio Lomnago (VA) - Italy
Tel. +39 0332 943211 -
www.gemini-alarm.com
ISO 90001 Certified Company



7854T

INSTALLER MANUAL



Made in Italy

AC2684 Rev.03 - 06/22

1.0 - PRELIMINARY ADVICE..... PAGE 02
 2.0 - ALARM POSITIONING.....PAGE 03
 3.0 - ACCESSORIES POSITIONING..... PAGE 04
 3.1 - Electronic key receptacle..... PAGE 04
 3.2 - Contact switch (optional)..... PAGE 04
 4.0 - ALARM UNIT SEALING..... PAGE 05
 5.0 - ALARM POSITIONING FOR MAXIMUM SENSITIVITY..... PAGE 06
 6.0 - ELECTRICAL CONNECTIONS.....PAGE 08
 7.0 - WIRING DIAGRAM AND PINOUT..... PAGE 09
 8.0 - DOUBLE ENGINE IMMOBILIZATION..... PAGE 10
 8.1- Electronic ignition..... PAGE 10
 8.2- Grounded wire..... PAGE 11
 9.0 - PAIRING NEW DEVICES..... PAGE 12
 9.1 - With Brown/Green wire connection..... PAGE 12
 9.2 - Without Brown/Green wire connection..... PAGE 13
 10.0 - PROGRAMMABLE FEATURES..... PAGE 14
 11.0 - PROGRAMMING EXAMPLE..... PAGE 15
 12.0 - REMOTE CONTROL..... PAGE 16
 13.0 - WASTE ELECTRICAL AND ELECTRONIC EQUIPMENT..... PAGE 17
 14.0 - TECHNICAL SPECIFICATIONS..... PAGE 17

PRELIMINARY ADVICE

Please read all instructions and understand them thoroughly before starting installation.

The following signal words are used throughout this manual to emphasize important instructions or special information.

⚠ WARNING

Non-compliance to this instruction could result in serious damage to the alarm system and the vehicle itself.

CAUTION

Non-compliance to this instruction may cause serious damage or operational failures to the alarm system.

NOTE

Provides useful installation tips.

2.0 - ALARM POSITIONING

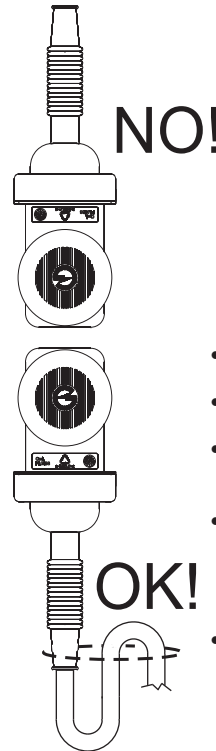

Do not install the alarm unit in this position as water ingress over time may seep through the rubber sheath and permanently damage the electronic circuit making the alarm system unreliable. Eventual malfunctioning due to water infiltration is not covered by warranty.

- Fit the alarm as shown in the picture opposite to prevent water entering the unit.
- Give the rubber sheath a 'goose-neck' bending as shown and secure with a tie wrap.
- The alarm unit must be installed in such a way as not to muffle the siren but it must not be exposed to atmospheric agents.
- Install the alarm away from moving mechanical parts, electric or electronic components that could generate high frequency electromagnetic disturbances and away from devices that could reach high temperatures when the vehicle is in use.
- Do not install the alarm unit directly on the vehicle frame.

⚠ WARNING

If a jet wash is used to clean the vehicle, protect the alarm unit from water splashes and be careful not to expose it to high pressure jets.

The warranty will not cover damages to the system due to water infiltrations caused by improper installation, improper jet washing or the use of non original accessories, not approved by the manufacturer.

3.0 - ACCESSORIES POSITIONING

3.1 - Override key receptacle

The receptacle with built-in LED must be installed where it can readily be seen and accessed by the user. Before drilling a hole in the plastic dash with a 13mm drill bit, check the position of the handlebars with the steering lock engaged. Make sure the LED will not be covered by the handlebars when the vehicle is parked.

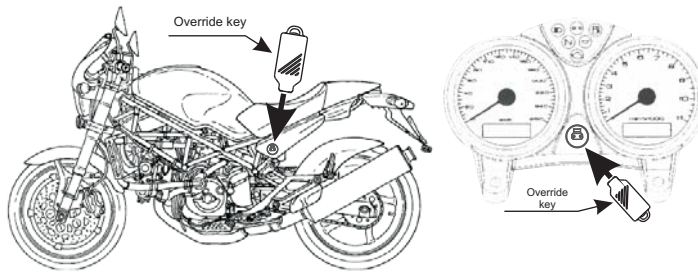

Example of receptacle positioning on the vehicle plastic side cover

3.2 - Contact switch (optional)

A contact switch can be fitted to protect the seat or topcase. It must be installed in such a way as to detect the opening of the seat/topcase without being accessible from the outside. The trigger threshold must be carefully set to avoid false alarms.

Do not ground the switch terminal to the vehicle frame make a connection to earth through a negative cable such as the indicator lamp negative lead.

NB: If no contact switch is fitted, the GREEN/BROWN wire will remain free for other possible uses such as programming the alarm or learning new devices.

4.0 - ALARM UNIT SEALING

To seal the alarm, position the rubber cap over the external edge of the alarm housing. Pull the plastic rectangular flange over the rubber cap and secure with the supplied screws. Do not over tighten.

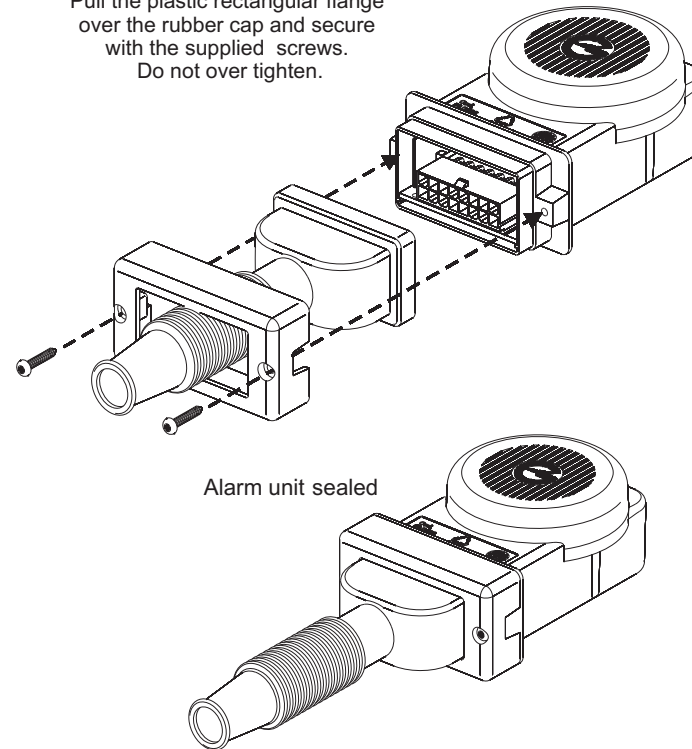

5.0 - ALARM POSITIONING FOR MAXIMUM SENSITIVITY

To ensure correct operation of the built-in motion sensor, install the alarm as illustrated below.

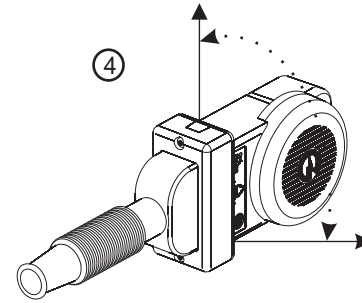
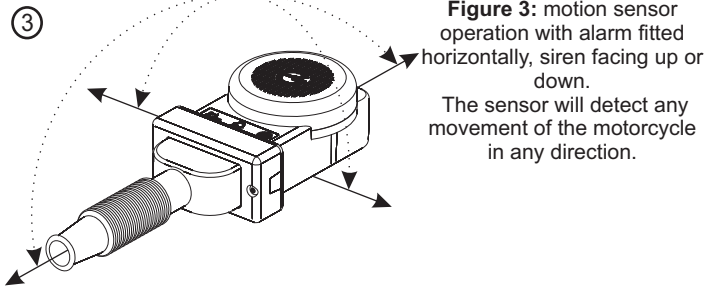
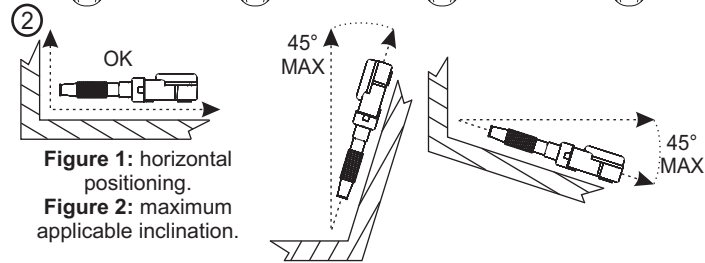
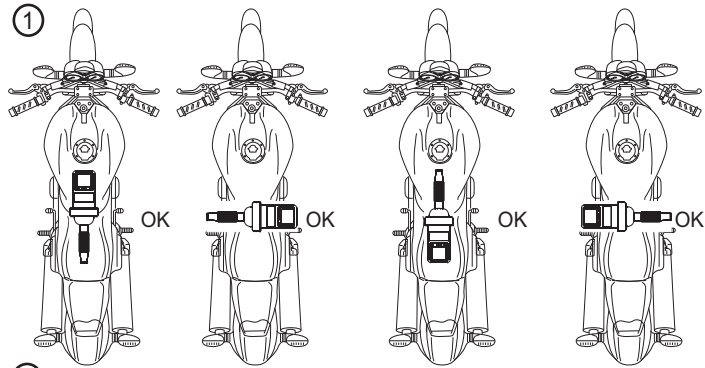

Figure 4: motion sensor operation with siren facing sideways (only for vehicles with a side stand). The alarm can be fitted on either the right or left side of the vehicle as long as the siren is turned towards the right side of the vehicle (opposite to the stand).

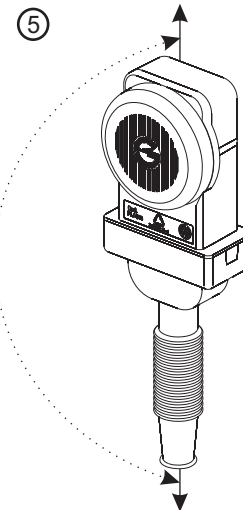

Figure 5: motion sensor operation with alarm fitted vertically (only for vehicles with a centre stand). To prevent water from entering the unit, the wire rubber sheath must be turned downwards.

NOTE: Prior to fitting, test the operation of the sensor to confirm it will work in the intended position.

6.0 - ELECTRICAL CONNECTIONS

WIRE COLOR	CONNECTION
Black marked "M"	Connect to battery negative terminal
Black marked "R"	Connect to battery positive terminal
Orange	Connect to right turn indicator light
Orange	Connect to left turn indicator light
Black marked "G"	Connect to ignition (+15/54)
Green/Brown	Connect to seat/topcase contact switch
-----	-----
Yellow/Black	Negative output in alarm
White/Violet	Device pairing

ENGINE IMMOBILISATION by CUTTING WIRES

WIRE COLOR	CONNECTION
BLACK marked "B"	Connect to key switch cut end
BLACK marked "H"	Connect to vehicle electric system cut wire
BLACK marked "HB"	Not applicable
BLACK marked "H1"	Connect to ignition switch positive
BLACK marked "B1"	Connect to ignition switch wire

ENGINE IMMOBILISATION by GROUNDING WIRES

WIRE COLOR	CONNECTION
BLACK marked "B"	Ground to negative (do not connect to vehicle chassis)
BLACK marked "HB"	Connect to the cable end which, if grounded, will lock the engine
BLACK marked "H"	Not applicable
BLACK marked "H1"	Connect to ignition switch positive
BLACK marked "B1"	Connect to ignition switch wire

7.0 - WIRING DIAGRAM AND PINOUT

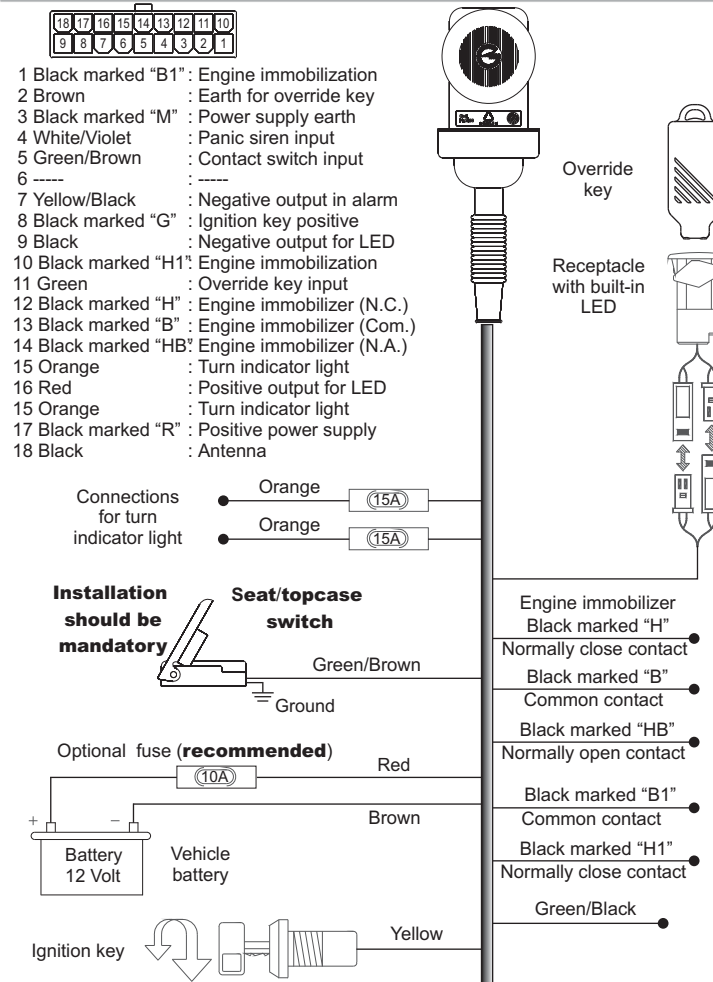

8.0 - DOUBLE ENGINE IMMOBILIZATION

8.2 Grounded wire

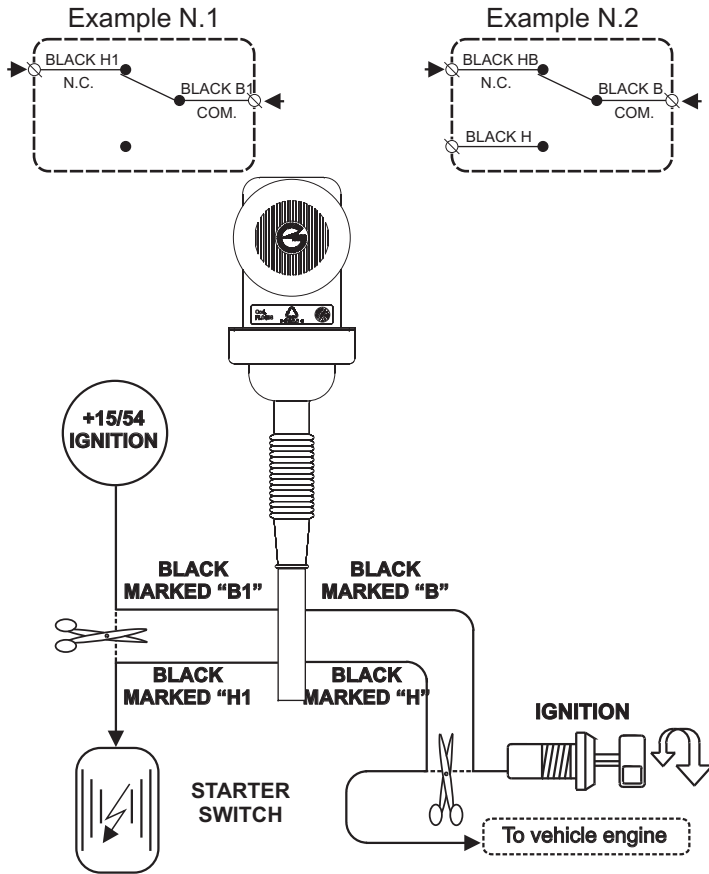

NOTE: above examples are merely indicative and not restrictive.

8.1 - Electronic ignition

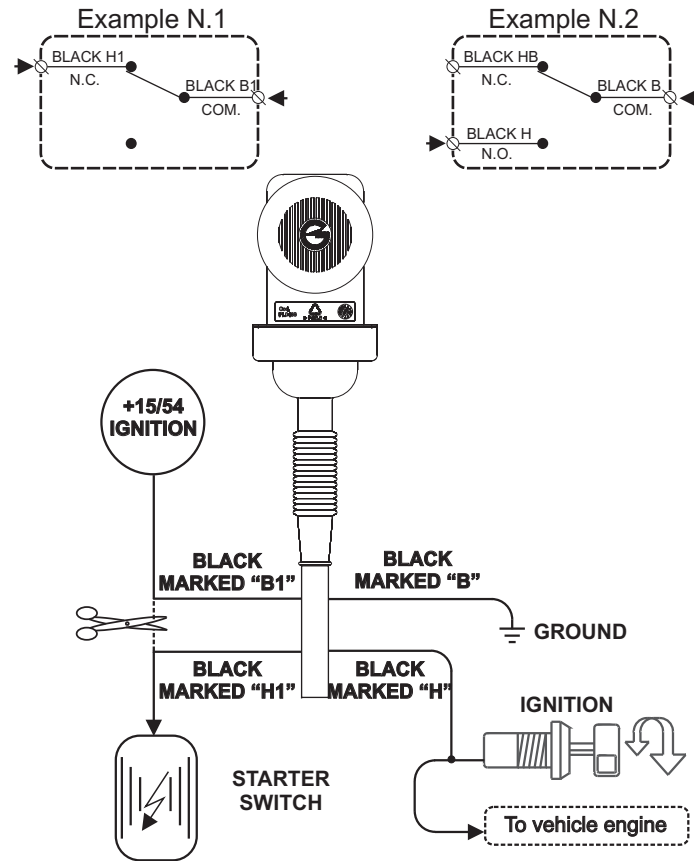

NOTE: above examples are merely indicative and not restrictive.

9.0 - PAIRING NEW DEVICES

9.1 - With BROWN/GREEN wire ground connection

The alarm is supplied with 2 remote controls and 1 override key but other optional devices can be added.

CAUTION

Alarm memory will only store 8 devices.
Saving an extra device will automatically delete the first one.

To pair a new device, proceed as follows:

- Make sure passive arming is disabled.
- Arm and then disarm the alarm via remote control or override key.
- Lift the seat or open the topcase or, if there is no contact switch, ground the BROWN-GREEN wire.
- Connect the WHITE-VIOLET wire to ground.
- Turn ignition key to ON.
- Two flashes of the turn indicators, a Beep and a Bop will confirm the system is in learn mode.
- Remove the WHITE-VIOLET wire from ground.
- Depending on which device is to be paired either press one of the remote control buttons OR touch the override key to its receptacle OR make the magnetic contact transmit (bring contact and magnet together and then move apart) OR press the button on the opening detector, make the infrared sensor or wireless hyper-frequency sensor transmit (refer to sensor instructions).
- A flash of the turn indicators and a Beep will confirm the operation has been completed successfully.
- To pair another device, ground the WHITE-VIOLET wire for 1 sec.
- To exit learn mode, turn ignition key OFF.
- A Bop and a flash of the turn indicators will confirm the end of the procedure.
- Close the seat/topcase or remove the BROWN/GREEN wire from ground.

9.2 - Without BROWN/GREEN wire ground connection

To pair a new device, proceed as follows:

- Make sure passive arming is disabled.
- Arm and then disarm the alarm via remote control or override key.
- Turn ignition key to ON
- The status LED will turn ON for 1 sec.;
- While the LED is ON, simultaneously press both buttons on the remote control or touch the override key to its receptacle.
- Two flashes of the turn indicators, a Beep and a Bop will confirm the system is in learn mode.
- Depending on which device is to be paired either press one of the remote control buttons OR touch the override key to its receptacle OR make the magnetic contact transmit (bring contact and magnet together and then move apart) OR press the button on the opening detector, make the infrared sensor or wireless hyper-frequency sensor transmit (refer to sensor instructions).
- If another device needs to be paired, wait 2 sec. before doing so.
- To exit learn mode, turn ignition key OFF.
- A Bop and a flash of the turn indicators will confirm the end of the procedure.

10.0 - PROGRAMMABLE FEATURES

To either enable or disable one of the programmable features proceed as indicated hereafter.

NB: Remember to ALWAYS arm and disarm the alarm before programming.

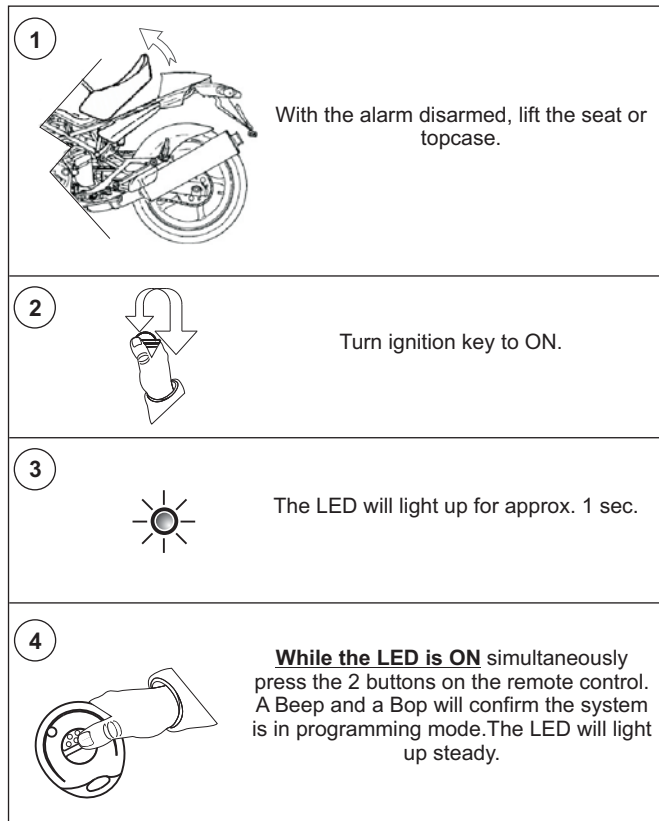

After pressing both buttons simultaneously (step 4), program the features according to your needs.

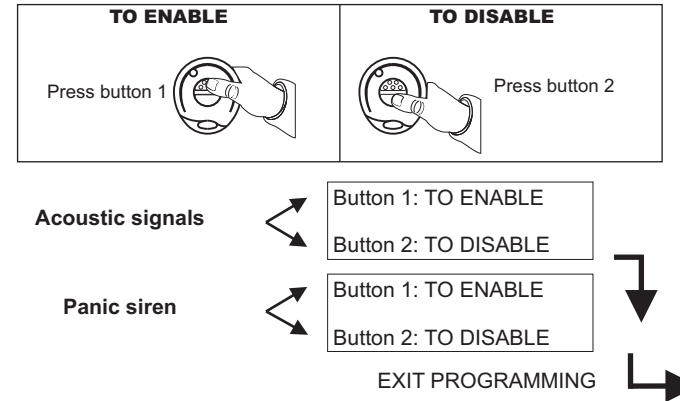

11.0 - PROGRAMMING EXAMPLE

To help you understand the programming procedure, here below is an example showing how to enable both features. Keep in mind that, at every button press, the system automatically scrolls to the next feature.

- With the alarm disarmed, lift the seat or open the topcase.
- Turn ignition key to ON; the LED will light up for 1 sec.
- While the LED is ON, simultaneously press the 2 buttons on the remote control. Two Beeps will confirm that the system is in programming mode. The LED will turn ON steady.
- Press remote control button 1, a Beep will confirm that acoustic signals have been enabled.
- Press button 1 again, a Beep will confirm that the panic siren has been enabled.
- When the last feature is programmed, the system automatically exits the programming mode. Three Bops followed by a Beep will confirm the end of the procedure. The status LED will also turn OFF.
- Turn ignition key OFF and close the topcase/seat.

NB: You can exit programming mode at any time by turning ignition key OFF. Programmed features will automatically be saved while the others will remain unvaried.

12.0 - REMOTE CONTROL

The remote control has 2 different function buttons each of which corresponds to a control signal that activates a selected action according to the operational condition and alarm configuration.

The textured button is for arming/disarming the alarm while the smooth button is used to exclude or trigger the siren.

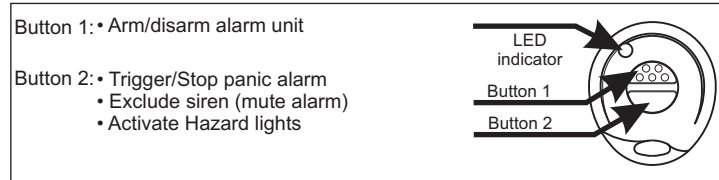

The remote control has a low charge battery indicator that gives you early warning to avoid malfunctioning. When the batteries are fully charged, the LED will show a steady light at the press of a button. If the batteries are too weak for normal operation, the LED will start blinking at the press of a button. To replace the batteries proceed as follows:

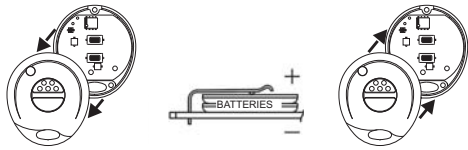

Separate the shell halves taking care not to damage the internal circuit.

Remove the discharged batteries and insert the new ones taking care not to invert the polarity.

Close the plastic shells and make sure the remote works properly.

⚠ WARNING

Use only CR1616 batteries.
Different type batteries can seriously damage the remote control unit.
Discard used batteries properly in special dedicated containers.

13.0 - WASTE ELECTRICAL AND ELECTRONIC EQUIPMENT

The present device falls within the field of application of the current WEEE Directive. The crossed-out wheeled bin symbol on the equipment or on its packaging indicates that the product, at the end of its useful life, must be discarded separately from other waste to allow adequate treatment and recycling.

The user must therefore take the equipment, at the end of its useful life, to an appropriate waste collection facility.



14.0 - TECHNICAL SPECIFICATIONS

Nominal supply voltage	12 Vdc
Load @ 12Vdc	< 1mA (alarm armed and LED flashing)
Load in sleep mode	< 1µA
Siren output level	118 dBA @ 1 meter
Relay capacity	8A